

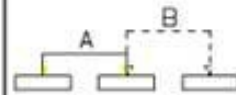

Non-shorting
shorting

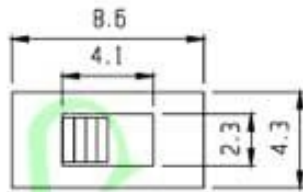

SCHEMATIC

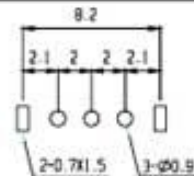

PCB LAYOUT

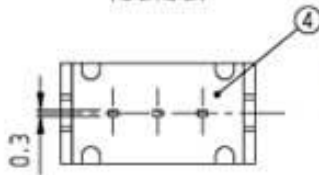
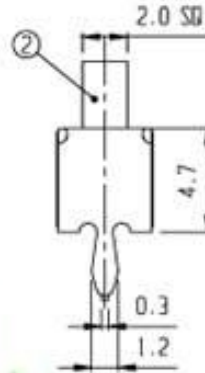
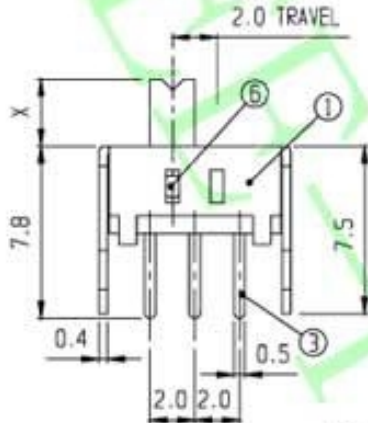

RoHS
Compliance

5	CONTACT	P B S	1	Ag PLATED	6	SPRING PLATE	P B S	1	
3	TERMINAL	BRASS	3	Ag PLATED	4	TERMINAL BASE	PHENOL RESIN	1	NATURAL
1	FRAME	SPCC	1	Ni PLATED	2	KNOB	P O M	1	VG 2-9
NO	PART	MATERIAL	QTY	REMARKS	NO	PART	MATERIAL	QTY	REMARKS

ISSUED		SPECIFICATION			TITLE: SLIDE SWITCH (1P2T)					
	RATING: DC 30V 0.3A				MODEL NO: SS-12D01(VG)					
	CONTACT RESISTANCE: 30mΩ max.				TOLERANCE	UNIT: MM	DWN.			
	INSULATION RESISTANCE: 500MΩ at 500V DC				UP TO 1.0:±0.1	SCALE: 4:1	CHK'D.			
	WITHSTAND VOLTAGE: AC 500V for 1 minute				1.0 TO 10.0:±0.2	VERSION: 02	APPD.			
	OPERATION FORCE: REFER ATTACH SPECIFICATION				OVER 10.0:±0.3	DRWG NO:				
SWITCHING LIFE: 10K cycles min.										
BY:	SEE-PLUS INDUSTRIAL LTD.									
DATE: 24-AUG-2006										